

# GO2cam

cam for workshops

GO2cam is a comprehensive high-end CAM solution for milling, turning and wire EDM.

## GO2Cam's Wire EDM Software



**GO2cam Wire EDM is a CAM combining power and ease of use.**

GO2cam International was founded in 2009, by a pioneer team in CAM software development. Our mission is to provide specific CAM solutions to simplify the NC programming.

GO2cam International offers mechanical solutions designed with same guidelines that make our success in other markets: innovation, accessibility and R&D reactivity.

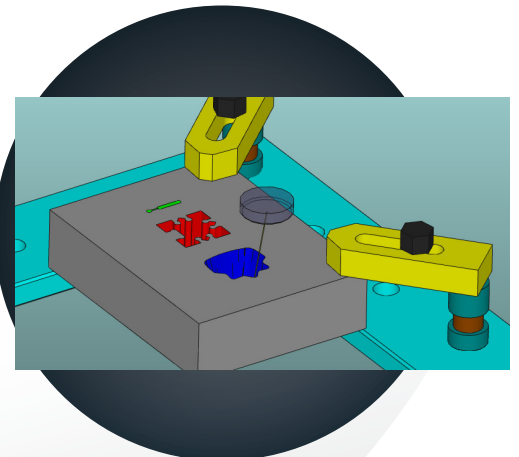

# GO2Cam's Wire EDM Software

## Technical characteristics

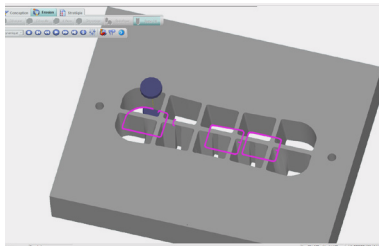

Partial cut, Slug cut, Finishing 2 ways

### ➔ CAD

- Open native CAD files
- Tolerancing
- Parametric functions Wireframe and Solid design
- Gear & tothing database\*
- Swiss turn tool manufacturing (STTM)\*\*

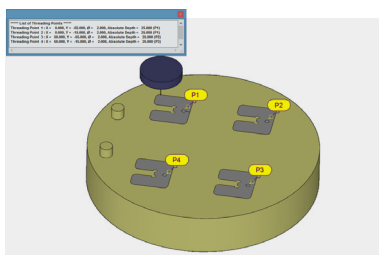

Threading point report

### ➔ CAM

- Command files, Script files, Technology tables,...
- 2X - Straight cut
- Taper cut
- 4X (G2/G3)
- Pocketting
- Automatic threading point creation and report
- Day / night optimization
- Slug management
- Specific corner strategy, no need to draw the shape

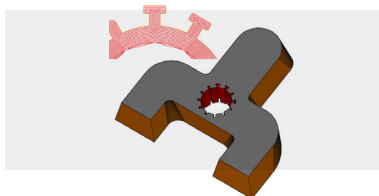

## > Specific EDM Geometry\*



### Gear:

Creation of parallel involute circle gears according to the ISO (NF E 23-001 to 005) and AGMA (American) Standards.

**Two types of gears are possible:**

- external gears
- internal gears



### Tothing:

Creation of rectilinear side involute circle splines according to the ISO (NF E 22-141) and AGMA (American) Standards.

**Two types of tothing are possible:**

- shaft
- hubs

## > Swiss Turning Tool Manufacturing (STTM)\*\*

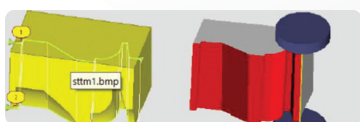

The STTM module enable to manufacture shape tools for turning, using 4 axis wire-cut. Only 10 minutes are necessary to program the toolpaths for such a type of shape, **a great time saving for the user!**

**GO2cam**  
INTERNATIONAL

6 Place des Terreaux 69001 Lyon - France  
+33 4 72 27 06 64 ▪ sales@go2cam.net

www.go2cam.net